

The Shops on Main St. 207 E Main St., Post Texas

X'd areas under lease

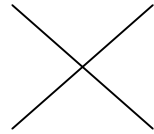

* Monthly Rates Listed
Both 6 month and 1 year lease rates shown

Entire Building Lease Options

207 E Main St. 4,554 sq. ft. 1.28 sq. ft. - \$15.37 Sq. Ft./ Yr. - 1 year lease = \$70,000/Year
 207 E Main St. 4,554 sq. ft. 1.18 sq. ft. - \$14.27 Sq. Ft./ Yr. - 3 year lease = \$65,000/Year
 207 E Main St. 4,554 sq. ft. 1.10 sq. ft. - \$13.18 Sq. Ft./ Yr. - 5 year lease = \$60,000/Year
 207 E Main St. 4,554 sq. ft. 1.01 sq. ft. - \$12.08 Sq. Ft./ Yr. - 10 year lease = \$55,000/Year

Suite L Store Front - 56 sq. ft.
 \$2.67 sq. ft. = \$150 per month (1 year lease)
 \$3.13 sq. ft. = \$175 per month (6 month lease)

Suite A - 223 sq. ft.
 Suite B - 463 sq. ft.
 Suite C - 286 sq. ft.
 Suite D - 604 sq. ft.
 Suite E - 242 sq. ft.
 Suite F - 247 sq. ft.
 Suite G - 264 sq. ft.
 Suite H - 526 sq. ft.

Suite L Store Front - 56 sq. ft.
 Suite M Store Front - 56 sq. ft.
 Suite N - 100 sq. ft.

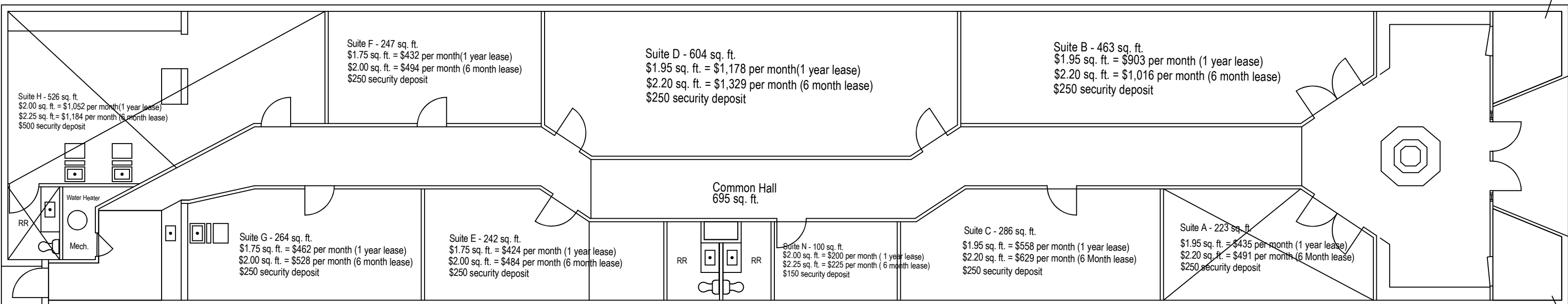

Break Area
78 sq. ft.

Suite M Store Front - 56 sq. ft.
 \$2.67 sq. ft. = \$150 per month (1 year lease)
 \$3.13 sq. ft. = \$175 per month (6 month lease)